

# DUOFIT D10

## SINGLE BOLT STRAIGHT VERSION

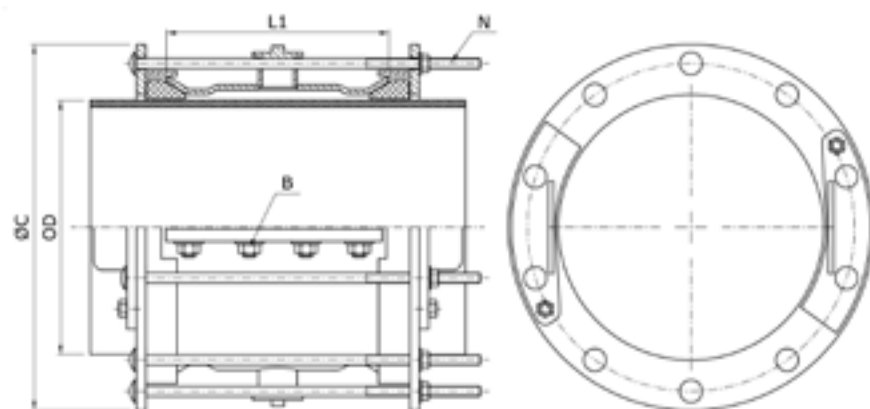

Straight version Duofit **D10** for repairs on damaged pipes (cracks, faulty weldings, corrosion, etc.) with no service cut off on pipes of any diameter. It can be also used for hot tapping techniques on pipes of any material and diameter with running fluids.

Other sizes or ranges on request

DN	Ø D		MOP (PN)	L1	Max. External Dimension Ø C	No. Flange Bolts N	No. Lateral Plates Bolts B	Weight
	Min.	Max.						
300	320	350	6-10-16	355	500	8	10	99
350	340	370	6-10-16		520	10		105
	360	390	6-10-16		540			108
400	390	420	6-10-16		580	12		113
	410	440	6-10-16		600			116
450	435	465	6-10-16		620	14		123
	460	490	6-10-16		640			127
500	490	520	6-10-16		680	16		132
	510	540	6-10-16		700			135
	535	565	6-10-16		720			142
600	560	590	6-10-16		740	18		146
	590	620	6-10-16		783			151
	620	650	6-10-16		813			160
700	645	675	6-10-16		838	20		164
	670	700	6-10-16		863			171
	695	725	6-10-16		888			175
	720	750	6-10-16		913			179
800	750	780	6-10-16		943	22		184
	780	810	6-10-16		973			189
	835	865	6-10-16		1028			200
900	860	890	6-10-16		1053	24		205
	895	925	6-10-16		1088			214
	925	955	6-10-16		1118			222
1000	955	985	6-10-16		1148	26		227
	985	1015	6-10-16		1178			232
	1000	1030	6-10-16		1193			237
	1030	1060	6-10-16		1223			241
1100	1060	1090	6-10-16		1253	28		246
	1080	1110	6-10-16	1273	250			
	1100	1130	6-10-16	1293	255			
	1130	1160	6-10-16	1323	260			
1200	1160	1190	6-10-16	1353	30	265		
	1185	1215	6-10-16	1378		270		
	1205	1235	6-10-16	1398		275		
1300	1235	1265	6-10-16	1428	32	280		
	1300	1330	6-10-16	1493		297		
	1335	1365	6-10-16	1528		303		
1400	1385	1415	6-10-16	1578	34	311		
	1410	1440	6-10-16	1603		318		
1500	1440	1470	6-10-16	1633	36	323		
	1510	1540	6-10-16	1703		337		
1600	1585	1615	6-10-16	1778	38	349		
	1610	1640	6-10-16	1803		356		
	1650	1680	6-10-16	1843		363		
1800	1825	1855	6-10-16	2018	40	403		
	1860	1890	6-10-16	2053		408		
2000	2020	2050	6-10-16	2213	42	442		
	2065	2095	6-10-16	2258		450		

This chart is for indicative purposes. Nova Siria srl can vary the indicated standards (tolerance range, dimensions and materials) according to specifications requested by Customers or to designing needs.

# DUOFIT D20-D

## DOUBLE BOLT STRAIGHT VERSION

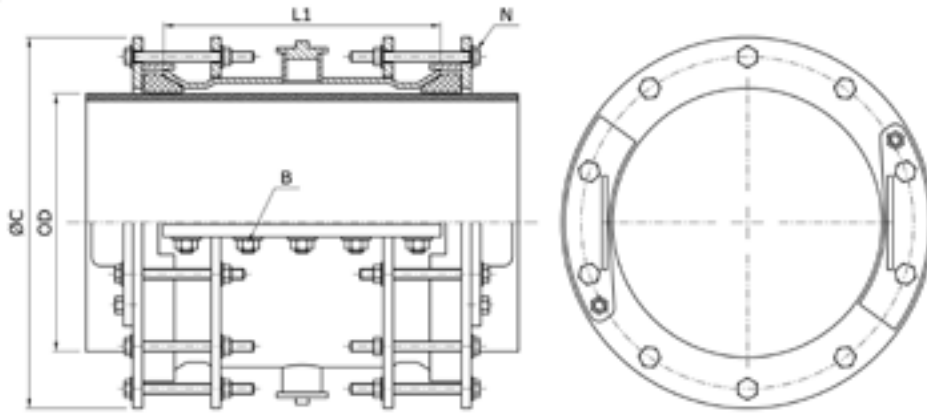

Straight version Duofit **D20** for repairs on damaged pipes (cracks, faulty weldings, corrosion, etc.) with no service interruption on pipes of any diameter. Can also be used for hot tapping techniques on pipes of any material and diameter with running fluids.

Other sizes or ranges on request

DN	Ø D		MOP (PN)	L1	Max. External Dimension Ø C	No. Flange Bolts N	No. Lateral Plates Bolts B	Weight
	Min.	Max.						
300	320	350	6-10-16	435	513	16	12	118
	350	370	6-10-16		533	20		125
350	360	390	6-10-16		553			24
	400	420	6-10-16		583	28		
400	410	440	6-10-16		603			32
	450	465	6-10-16		628	36		
450	435	490	6-10-16		653			40
	500	520	6-10-16		683	44		
500	490	540	6-10-16		703			48
	550	565	6-10-16		728	52		
550	535	590	6-10-16		753			56
	600	620	6-10-16		783	60		
600	590	650	6-10-16		813			64
	650	675	6-10-16		838	68		
650	620	700	6-10-16		863			72
	700	725	6-10-16		888	76		
700	695	750	6-10-16		913			80
	750	780	6-10-16		943	84		
750	720	810	6-10-16		973			88
	800	835	6-10-16		1028	92		
800	860	890	6-10-16		1053			96
	900	925	6-10-16		1088	100		
900	925	955	6-10-16		1118			104
	950	985	6-10-16		1148	108		
950	955	1015	6-10-16	1178	112		273	
	1000	1030	6-10-16	1193		116	279	
1000	1030	1060	6-10-16	1223	120		285	
	1060	1090	6-10-16	1253		124	291	
1060	1060	1110	6-10-16	1273	128		297	
	1100	1130	6-10-16	1293		132	301	
1100	1130	1160	6-10-16	1323	136		308	
	1160	1190	6-10-16	1353		140	314	
1160	1185	1215	6-10-16	1378	144		320	
	1200	1235	6-10-16	1398		148	325	
1200	1235	1265	6-10-16	1428	152		333	
	1300	1330	6-10-16	1493		156	339	
1300	1335	1365	6-10-16	1528	160		359	
	1385	1415	6-10-16	1578		164	366	
1385	1410	1440	6-10-16	1603	168		376	
	1440	1470	6-10-16	1633		172	384	
1440	1510	1540	6-10-16	1703	176		390	
	1585	1615	6-10-16	1778		180	407	
1585	1610	1640	6-10-16	1803	184		422	
	1650	1680	6-10-16	1843		188	431	
1650	1825	1855	6-10-16	2018	192		439	
	1860	1890	6-10-16	2053		196	488	
1860	2020	2050	6-10-16	2213	200		495	
	2065	2095	6-10-16	2258		92	536	
2065					96	545		

This chart is for indicative purposes. Nova Siria srl can vary the indicated standards (tolerance range, dimensions and materials) according to specifications requested by Customers or to designing needs.