

# DUOFIT D30

## SHAPED VERSION

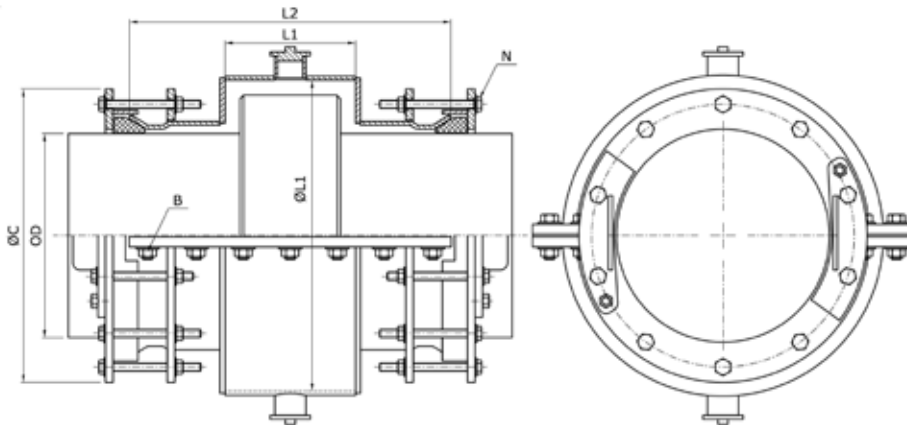

Duofit **D30** shaped version for repair sleeve collars of asbestos cement pipes, DCI pipes sockets, on a "GIBALTA" type joints, PE electrowelded fittings without interruption of supply.

**Duofit D30** version can be also used for hot tapping techniques on pipes of any material and diameter with running fluids.

### D30 for cast iron pipes

Other sizes or ranges on request

DN	ØD		MOP (PN)	Shaping Length L1	Shaping ID ØL1	Total Length L2	Max. External Dimension ØC	No. Flange Bolts N	No. Lateral Plates Bolts B	Weight
	Min.	Max.								
350	360	390	6-10-16	260	500	752	553	16	22	215
400	415	445	6-10-16		560		608	20		
450	465	495	6-10-16		600		658	24		
500	515	545	6-10-16		670		708	24		
600	615	645	6-10-16		780		808	28		
700	720	750	6-10-16		890		913	32		
800	825	855	6-10-16	300	1000	1018	36	26	379	
900	930	960	6-10-16		1110	1123	40			
1000	1030	1060	6-10-16		1220	1223	44			
1100	1135	1165	6-10-16		1320	1328	48			
1200	1240	1270	6-10-16		1430	1433	52			
1400	1445	1475	6-10-16		1680	1638	60			
1600	1650	1680	6-10-16	350	1890	1843	68	26	700	
1800	1860	1890	6-10-16		1940	2053	76			
2000	2065	2095	6-10-16		2140	2258	84			

### D30 for asbestos cement pipe 10

300	330	360	6-10-16	260	460	752	523	16	22	202	
350	385	415	6-10-16		520		578	20			
400	440	470	6-10-16		600		633	24			
450	495	525	6-10-16		660		688	24			
500	555	585	6-10-16		730		748	28			
600	665	695	6-10-16		850		858	32			
700	780	810	6-10-16	300	990	973	32	26	376		
800	890	920	6-10-16		1120	1083	36				
900	1005	1035	6-10-16		1240	1198	44				
1000	1120	1150	6-10-16		1360	1313	48				
											463
											503

### D30 for SDR 17 PE pipes on electrowelded body

355	340	370	6-10-16	350	460	842	533	20	26	219
400	385	415	6-10-16	400	520	892	578	20	30	244
450	435	465	6-10-16	440	560	932	628	24		266
500	485	515	6-10-16	460	620	952	678	24		288
560	545	575	6-10-16	500	680	992	738	28	32	316
630	615	645	6-10-16	550	770	1042	808	28		356
710	695	725	6-10-16		870		888	32		34
800	785	815	6-10-16		970		978	32	36	426
900	885	915	6-10-16	570	1080	1062	1078	36	38	472
1000	985	1015	6-10-16		1190		1178	40	40	513
1100	1085	1115	6-10-16		600		1290	1092	1278	44
1200	1185	1215	6-10-16	620	1410	1112	1378	48	48	612

This chart is for indicative purposes. Nova Siria srl can vary the indicated standards (tolerance range, dimensions and materials) according to specifications requested by Customers or to designing needs.